

## Storage-type Gelled Battery

- Completely sealed and maintenance-free, low self-discharge
- 100% precise quality testing, stable quality and high reliable performance
- Unique grid alloy formula, Gelled electrolyte formula and updated manufacturing technique
- Floating & standby use: up to 12 years
- Cycle use 1: Up to 350 cycles at 100% DOD
- Cycle use 2: Up to 1800 cycles at 30% DOD

## Application:

- Telecommunications
- Uninterruptable Power Supply (UPS)
- Electric Power System (EPS)
- Emergency backup power supply
- Alarm and security system
- Communication power supply
- DC power supply
- Auto control system

## Construction:

- Component .....Raw material
- Positive .....Lead dioxide
- Negative .....Lead
- Container .....ABS
- Cover .....ABS
- Sealant .....Epoxy
- Safety valve .... Rubber
- Terminal .....Copper/Pb
- Separator .....Fiber glass
- Electrolyte ..... Sulfuric acid

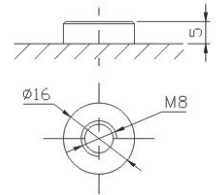
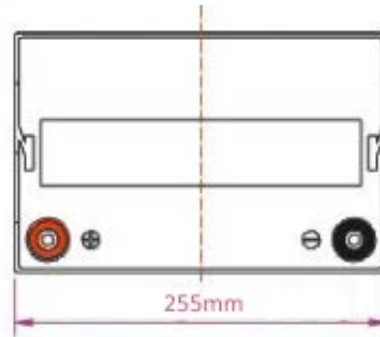
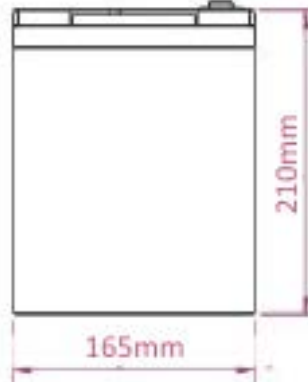
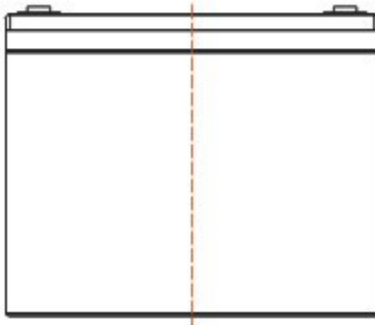

B4 Terminal

## Speification:

Battery Model	MNG 80-12 12V80AH			
Designed Floating Life	Up to 12 Years			
Capacity (25°C)	20HR(4.04A, 10.8V)	10HR(8.00A, 10.8V)	5HR(13.18A, 10.5V)	1HR(44.56A, 10.5V)
	80.80AH	80.00AH	65.88AH	44.56AH
Dimensions	Length	Width	Height	Total Height
	260mm (10.24inch)	167mm (6.57inch)	211mm (8.31inch)	216mm (8.50inch)
Approx. Weight	22.50Kg (49.60 lbs) ± 5%			
Internal Resistance	Full charged at 25°C: ≤ 7.5mΩ			
Self Discharge	2% of capacity declined per month at (25°C)			
Capacity Affected by Temp.(20HR)	40°C	25°C	0°C	-15°C
	102%	100%	85%	65%
Charge Voltage(25°C)	Cycle use		Float use	
	14.4-14.6V(-30mV/°C), max. Current:24.00A		13.6-13.8V (-20mV/°C)	

### Terminal Voltage (V) and Discharge Time

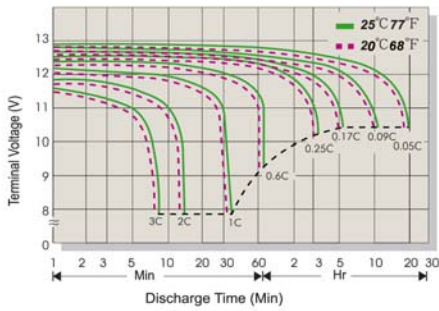

### Capacity Retention Characteristic

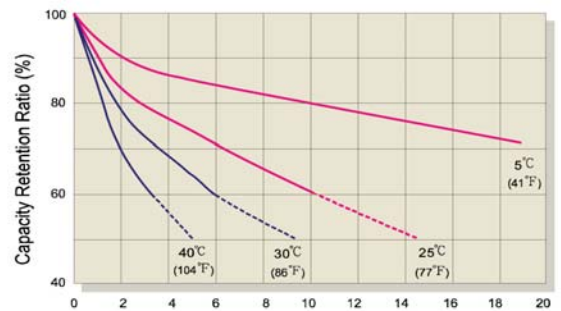

### Battery Voltage and Charge Time for Standby Use

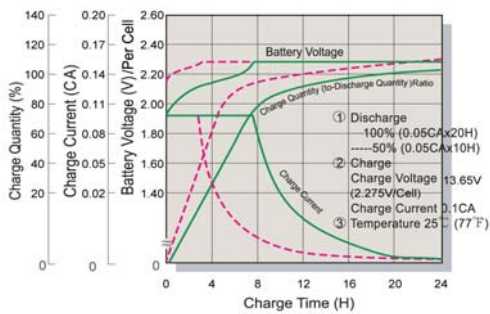

### Battery Voltage and Charge Time for Cycle Use

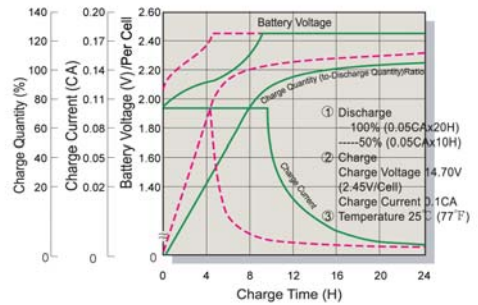

### Tickle(or Float) Service Life

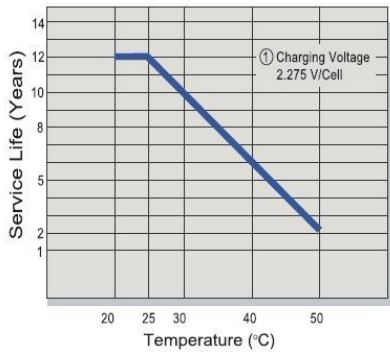

### Cycle Service Life

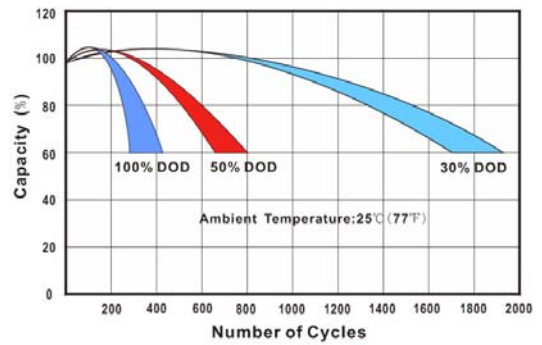

### Constant Current Discharge(CC,Unit:A) at 25°C(77°F)

F.V/Time	5Min	10Min	15Min	30Min	1Hr	2Hr	3Hr	4Hr	5Hr	6Hr	10Hr	20Hr
1.85V/Cell	180.56	133.12	115.68	69.76	41.12	24.23	18.04	15.22	12.53	11.53	7.68	3.84
1.80V/Cell	186.96	137.92	120.08	72.40	42.88	25.25	18.84	15.86	13.05	12.01	8.00	4.04
1.75V/Cell	206.56	145.12	126.16	75.28	44.56	25.99	19.38	16.02	13.18	12.13	8.08	4.06
1.70V/Cell	229.68	152.00	132.08	78.96	45.44	26.47	19.75	16.17	13.30	12.25	8.16	4.11
1.67V/Cell	254.72	158.88	138.16	81.04	47.12	27.22	20.34	16.33	13.44	12.37	8.24	4.14

### Constant Power Discharge (CP,Unit:W) at 25°C(77°F)

F.V/Time	5Min	10Min	15Min	30Min	1Hr	2Hr	3Hr	4Hr	5Hr	6Hr	10Hr	20Hr
1.85V/Cell	343.12	252.88	219.76	132.56	78.08	46.00	34.27	28.91	23.80	21.90	14.59	7.30
1.80V/Cell	355.20	262.00	228.16	137.60	81.44	48.00	35.80	30.12	24.80	22.82	15.20	7.61
1.75V/Cell	392.48	275.68	239.60	143.04	84.72	49.36	36.81	30.42	25.04	23.05	15.35	7.69
1.70V/Cell	436.48	288.80	250.96	150.00	86.32	50.32	37.52	30.72	25.29	23.27	15.50	7.76
1.67V/Cell	484.00	301.92	262.48	154.00	89.52	51.68	38.64	31.02	25.54	23.50	15.66	7.84